

# Agent EHS 550

## DECT Connection Box

### SET-UP GUIDE

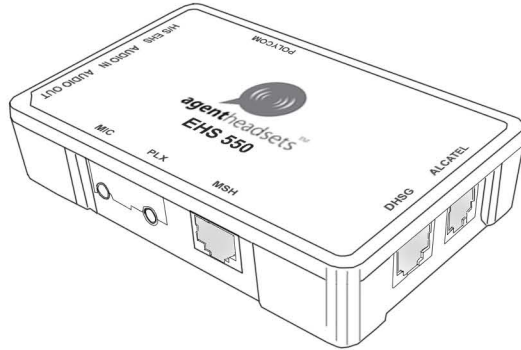

For use with Toshiba deskphones

### What's in the box:

Agent EHS 550

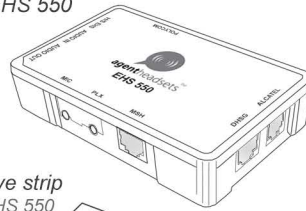

Cable A



Ringer Sensor



Adhesive strip  
(to fix EHS 550  
to your desk)



### You will also need:

Toshiba  
deskphone



Agent W860  
or W880



Cable B  
(supplied  
with your  
Agent  
W860 or  
W880)



### Compatibility guide:

The Agent EHS 550 is compatible with the following Toshiba models:

- |            |            |           |           |
|------------|------------|-----------|-----------|
| • DKT 2001 | • DKT 3007 | • DP 5008 | • IP 5022 |
| • DKT 2010 | • DKT 3010 | • DP 5018 | • IP 5122 |
| • DKT 2020 | • DKT 3014 | • DP 5022 | • IP 5131 |
| • IPT 2008 | • DKT 3020 | • DP 5032 | • IP 5132 |
| • IPT 2010 |            | • DP 5122 | • IP 5631 |
| • IPT 2020 |            | • DP 5130 | • IP 5522 |
|            |            | • DP5132  | • IP 5622 |

\*\*\* All DKT 2000 and 3000 series  
handsets must have the BHEU card  
fitted to be compatible with the EHS 550.

### Other manufacturers:

Other versions of this product are available for the following manufacturers:

Aastra



Alcatel



Avaya



Panasonic



Polycom



Siemens



To check which handsets from each manufacturer are compatible,  
please visit the accessories section of our website: [www.agentheadsets.com](http://www.agentheadsets.com)

**PLEASE NOTE:** If you're using a DKT 2000 or 3000 series  
handset, you must have the BHEU card fitted for it to be  
compatible with the Agent EHS 550.

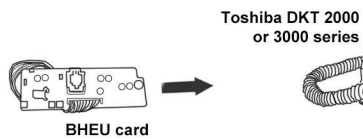

### Step 1: Connect Cable A

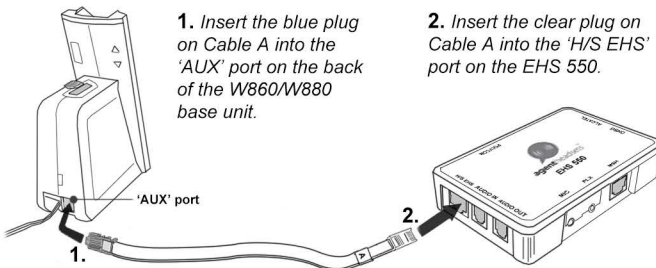

1. Insert the blue plug  
on Cable A into the  
'AUX' port on the back  
of the W860/W880  
base unit.

2. Insert the clear plug on  
Cable A into the 'H/S EHS'  
port on the EHS 550.

### Step 2: Connect Cable B

Cable B is supplied with your Agent W860 or W880.

1. Insert either end of Cable B into the 'TEL' port  
on the underside of your base unit.

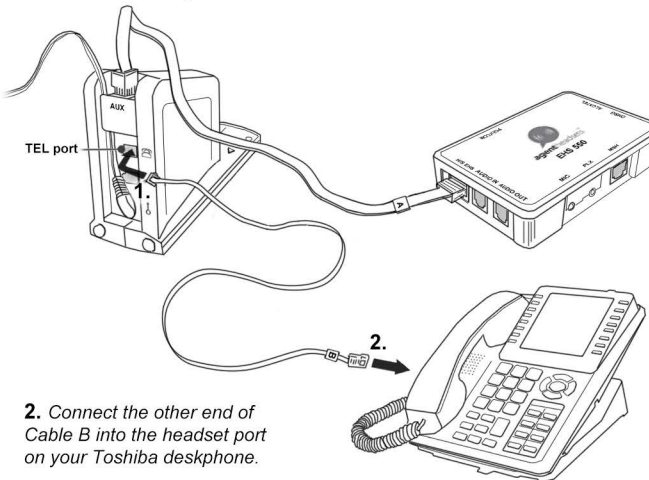

2. Connect the other end of  
Cable B into the headset port  
on your Toshiba deskphone.

Please check your deskphone's manual for location of the headset port.

### Step 3: Connect the Ringer Sensor

1. Insert the audio jack on the Ringer Sensor into the 'MIC' port  
on the EHS 550.

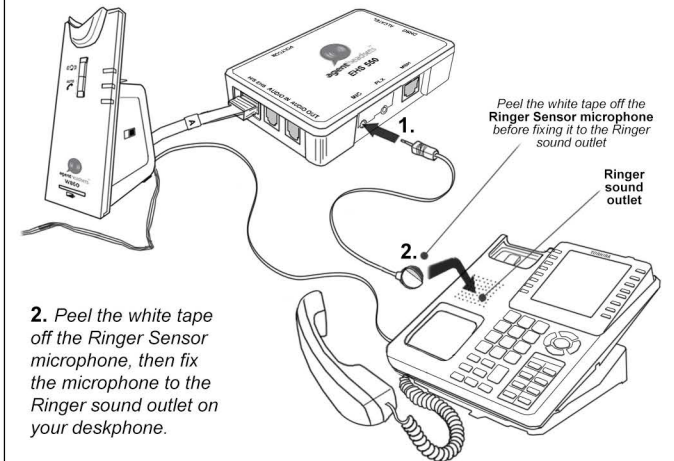

2. Peel the white tape off the  
Ringer Sensor microphone,  
then fix the microphone to the  
Ringer sound outlet on  
your deskphone.

Your EHS 550 will now be ready for use with your Agent W860 or W880  
and Toshiba deskphone. If you encounter any problems setting up or  
operating your products, please call Agent headsets on 0845 873 8085.